

I-75 / US-23

VIENNA ROAD

LINDEN ROAD

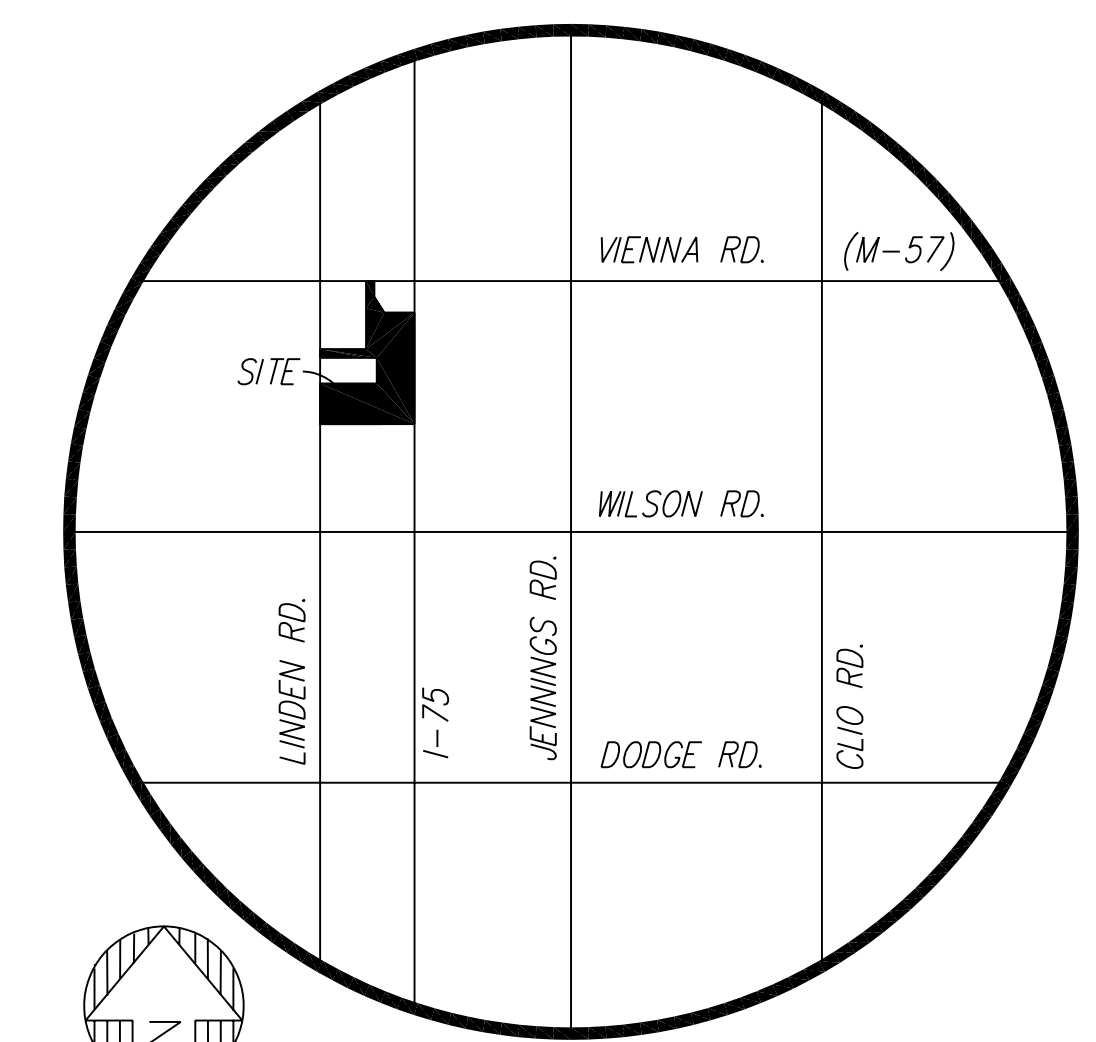

VICINITY MAP

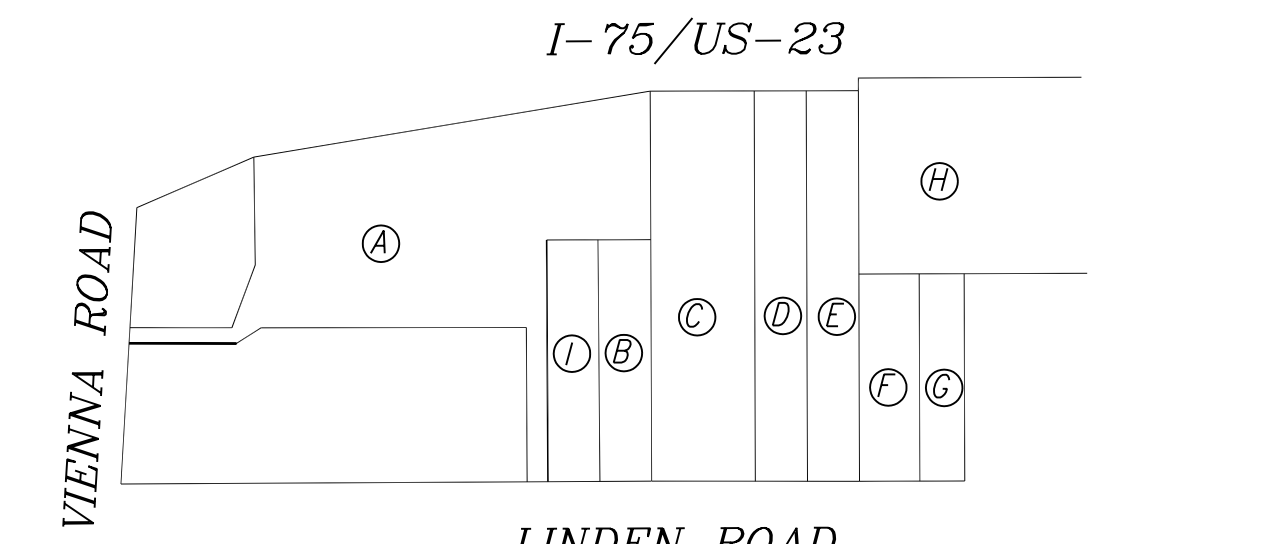

PARCEL DESIGNATION DETAIL

**SITE DESIGN CRITERIA:**

**ZONING:**  
 PARCEL A: C-4 (OWNER: LEE SUTHERLAND)  
 PROPOSED REZONING TO C-2  
 PARCEL B: C-2 (OWNER: FRANCIS CORCORAN)  
 PARCEL C: C-2 (OWNER: MORSE DEVELOPMENT, LLC)  
 PARCEL D: C-2 (OWNER: MORSE DEVELOPMENT, LLC)  
 PARCEL E: C-2 (OWNER: MORSE DEVELOPMENT, LLC)  
 PARCEL F: C-2  
 PARCEL G: C-2  
 PARCEL H: C-2 & OR  
 PARCEL I: C-4 (OWNER: LINDEN ROAD CENTER, LLC)

**SETBACKS:** BUILDING (C-4 ZONING) BUILDING (C-2 ZONING)  
 FRONT: 100 FT 60 FT  
 SIDE: 42 FT 14 FT  
 REAR: 52 FT 42 FT

**MINIMUM PARKING SPACE DIMENSIONS AND CRITERIA:**  
 - 9 FT x 20 FT WITH 20 FT AISLE

**PARKING SPACE REQUIREMENTS:**  
 CALCULATIONS ARE BASED ON USABLE FLOOR AREA (UFA) WHICH IS DEFINED AS THAT AREA USED FOR THE SALE OR MERCHANDISE, OR SERVICES, OR FOR USE TO SERVE CLIENTS OR CUSTOMERS. STORAGE AND UTILITIES AREAS ARE EXCLUDED FROM UFA.

- BANKS AND FINANCIAL INSTITUTIONS: 1 PER 125 SF
- RETAIL STORES: 1 PER 150 SF
- OFFICE SPACE: 1 PER 200 SF
- RESTAURANT (STANDARD): 1 PER 75 SF
- RESTAURANT (DRIVE-THROUGH): 1 PER 25 SF
- HOTEL: 1 PER OCCUPANT UNIT, AND 50 % OF THAT REQUIRED FOR ACCESSORY USES.

**LOADING REQUIREMENTS:**

- 10 SF PER FRONT FOOT OF BUILDING.

**LANDSCAPE AND BUFFER REQUIREMENTS:**

- INTERIOR LOT LANDSCAPING: NO REQUIREMENTS.

**TRAFFIC COUNT CRITERIA**

ROAD	JURISDICTION	AADT	DATA ACQUISITION
I-75	MDOT	59,000	2005
VIENNA ROAD (M-57) EAST	MDOT	17,600	2005
VIENNA ROAD (M-57) WEST	MDOT	11,700	2005
LINDEN ROAD NORTH	GENESSEE COUNTY	4,257	2004*
LINDEN ROAD SOUTH	GENESSEE COUNTY	3,922	2006

\* = CURRENT DATA NOT AVAILABLE DUE TO ROAD WIDENING

AAOT = AVERAGE ANNUAL DAILY TRAVEL

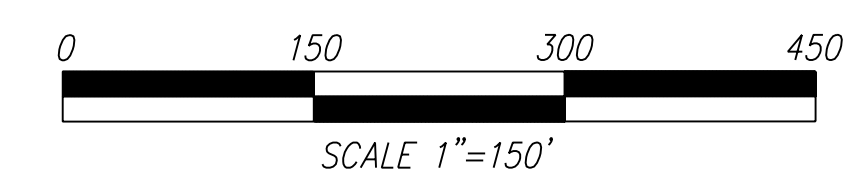
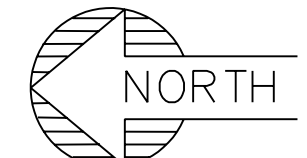

SCALE 1"=150'

PREPARED BY:  
**GENESIS**  
 LAND DEVELOPMENT, INC.  
 2838 WOODDELM  
 ROCHESTER HILLS, MI 48309  
 248.852.1174 PHONE/FAX  
 www.genesislanddev.com

OWNER:  
 MORSE DEVELOPMENT, LLC  
 P.O. BOX 310  
 CLIO, MI 48420  
 810-686-0760

PROJECT:  
 LINDEN ROAD I-75 DEVELOPMENT  
 LOCATION:  
 LINDEN ROAD & I-75  
 VIENNA TOWNSHIP, MI

REVISION

12-07-06	OWNER REVIEW
12-12-06	OWNER REVIEW
01-30-07	OWNER REVIEW

PROJECT MANAGER:  
 L. HOEFLEIN

PROJECT NO.  
 BV002

SHEET NO.:  
 CON-6